

auto electrical parts

Technical Information Sheet

Part No. 0-445-85

Low profile Amber LED beacon, 12-110 volt dc with polycarbonate amber lens and 3 bolt fixing. 4 Flash Patterns: Single, Double, Quad (45p/m) & Rotating. 5 high intensity LED's. I 130 x w 130 x h 95mm. CE approved.

Additional Information

The beacon is supplied with flying leads (350mm), foam gasket, three 5 x 45mm bolts and 2 butt connectors.

To change flash patterns please remove the lens and use the jumper to select flash pattern required. See image below:

Technical Drawing (not to scale)

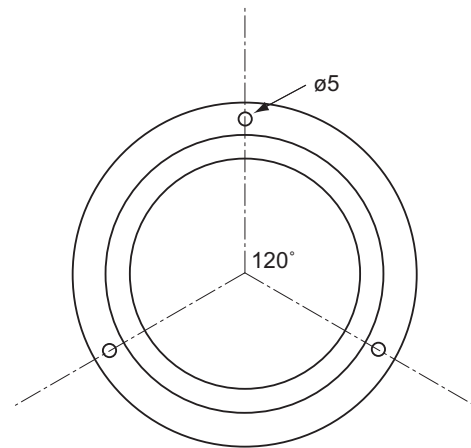
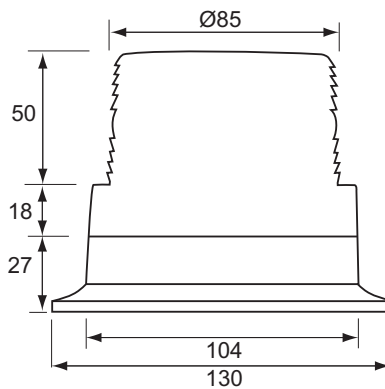
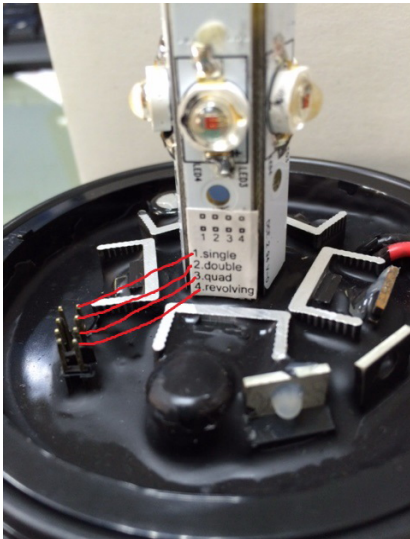

Specification

Type	High intensity
Colour	LED beacon Amber
Number of LEDs	5 x 1 watt
Voltage rating	12 - 110 volt dc
Current	0.35 amp @ 12 volt dc
Flash Patterns	Single, Double, Quad (45fpm) and Rotating (selected by jumper)
Lens material	Polycarbonate
Flying leads	350mm
Weight	400g
Dimensions	I 130 x w 130 x h 95mm
Approvals	CE
Protection	Waterproof against spray

The information contained in this document is correct to the best of our knowledge at the time of printing. However, specifications may change at any time without notice.